

Pipe flap valve DN 300

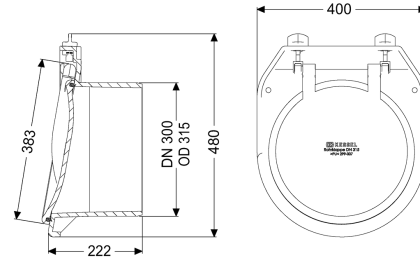

Article information

Item no.: 79300
 GTIN: 4026092011652
 Price group: 10

Advantages

- For universal use in salt and fresh water environments
- Low weight for simple installation with high mechanical strength
- High tightness: seals airtight even with low counter-pressure

Description

The pipe flap valve serves as an end piece and has a mechanical flap which closes automatically.

Variant

Mechanical backwater flaps: 1

General characteristics

| | |
|-------------------------|-----------------------|
| Colour: | black |
| Material: | Polymer |
| Nominal size (DN): | 300 |
| Outer diameter (OD): | 318 mm |
| Type of wastewater: | without sewage |
| Installation situation: | exposed drainage pipe |
| Delivery state: | installation-ready |

Dimensions

| | |
|----------------------|---------|
| Net weight: | 5,74 kg |
| Gross weight: | 8,16 kg |
| Length: | 225 mm |
| Width: | 400 mm |
| Height: | 450 mm |
| Packaging dimension: | length |

Packaging dimension:
Packaging dimension:

width
height